

Mathematics, Grade 6

- 37 Shani saved three times as much money as Bill. If Bill saved d dollars, which expression shows how much money Shani saved?
- A. $3d$
 - B. $\frac{d}{3}$
 - C. $d + 3$
 - D. $d - 3$

Reporting Category for Item 37: **Patterns, Relations, and Algebra**

Mathematics, Grade 6

- 38 On Kenesha's last business trip she drove 820 miles. Her company pays her \$0.32 per mile. Which of the following is **closest** to the amount Kenesha's company will pay her for the miles she drove?
- A. $\frac{1}{4}$ of 800
 - B. $\frac{1}{3}$ of 800
 - C. $\frac{1}{4}$ of 900
 - D. $\frac{1}{3}$ of 900

Reporting Category for Item 38: *Measurement*

- 39 An architect measured the three angles marked in the diagram below.

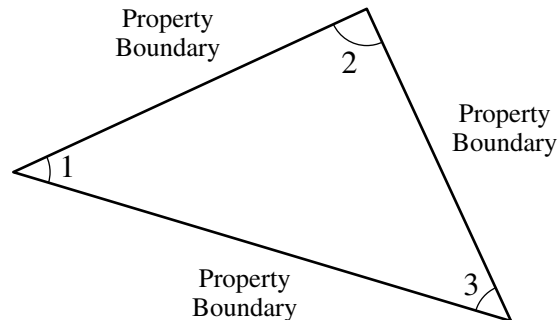

- What was the sum of the measures of the three angles?
- A. 180°
 - B. 210°
 - C. 270°
 - D. 360°

Reporting Category for Item 39: *Measurement*